



With Surface Mounting Box

Recessed



### Features

#### Color

- Standard: white, almond.
- Optional (upcharge applicable): metallic silver, bronze, metallic charcoal, aluminum, semi-gloss black, sand.
- Custom colors available upon request.

#### Finish

- Standard: epoxy/polyester powder paint.

#### Voltage

- 120V, 208V, 240/208V, 1-phase.

#### Construction

- 20-gauge steel cabinet.
- 22-gauge steel front cover.
- High-limit temperature control with automatic reset.

#### Fan

- Quiet fan operating.
- 500W to 1000W; 40 cfm fan and 1250W to 2000W; 80 cfm fan.
- Factory-lubricated motor.

#### Heating element

- Durable tubular heating element with fins.
- Factory sealed element upon request.

#### Control

- Built-in thermostat available with a control knob or tamperproof.

*Note: If an electronic thermostat is used, it must be compatible with forced-air heaters.*

#### Installation

- Wall installation only.
- The air outlet should be installed at least 4 in. (102 mm) from flooring withstands temperature and 10 in. (254 mm) from linoleum flooring.
- Quick installation with recess box mounting holes.
- Large wiring compartment.
- May be recessed in 2 in. X 3 in. stud partitions.
- Surface mounting box available.
- Tight fit with V-shaped recess box.

#### Warranty

- 5-year warranty against defects.

#### Application

- Entrance way, kitchen, bathroom, family room, basement.

Four mounting positions available. Pictures showing front panel. Directional vane air flow.

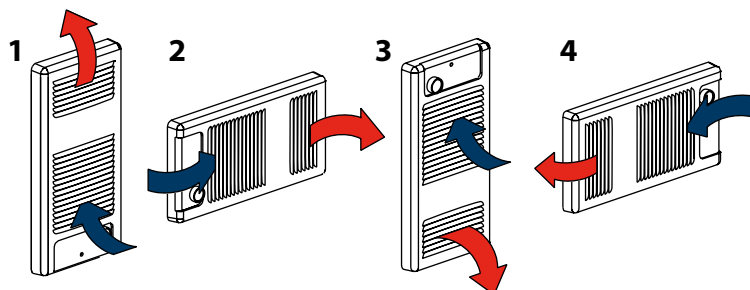

Product #	Volts	Watts	Weight	
			lb	kg
OVSU0502	120	500	9.0	4.1
OVSU0752	120	750	9.0	4.1
OVSU1002	120	1000	9.0	4.1
OVSU1252	120	1250	9.0	4.1
OVSU1502	120	1500	9.0	4.1
OVSU0500	240/208	500/375	9.0	4.1
OVSU0750	240/208	750/563	9.0	4.1
OVSU1000	240/208	1000/750	9.0	4.1
OVSU1250	240/208	1250/938	9.0	4.1
OVSU1500	240/208	1500/1125	9.0	4.1
OVSU2000	240/208	2000/1500	9.0	4.1
OVSU2008	208	2000	9.0	4.1

Options

Product # Kit	Product # Factory installed*	Description
KIT-OVS-BS	-	Surface mounting box
KIT-OVS-DIS <sup>1</sup>	DIS <sup>1</sup>	Disconnect switch, 20A at 277V max. (120V, 208V, 240/208V only)
-	ES <sup>2</sup>	Factory sealed element (120V, 208V, 240/208V only)
KIT-OVS-TB6	TB6	Single-pole bi-metal thermostat (347V factory installed only)
KIT-OVS-TB26 <sup>3</sup>	TB26 <sup>3</sup>	Double-pole bi-metal thermostat (347V factory installed only)
KIT-OVS-TB6-AV	TB6AV	Single-pole bi-metal tamperproof thermostat (347V factory installed only)
KIT-OVS-TB26-AV <sup>3</sup>	TB26AV <sup>3</sup>	Double-pole bi-metal tamperproof thermostat (347V factory installed only)

\* For factory installed options, add the option number to the product number. See the **Product Code** section inside the front cover.

<sup>1</sup> For the U.S. only: The nominal current of the unit must not exceed 80% of the capacity of the disconnect.

<sup>2</sup> The option "sealed element" increases the reliability of these in humid environments. It does not completely eliminate the leakage currents of metal sheathed heating elements.

<sup>3</sup> "Off" position.

Add "BL" for white, "AM" for almond.

Optional colors shown in the color chart section are available upon request.

